

@ Architecture

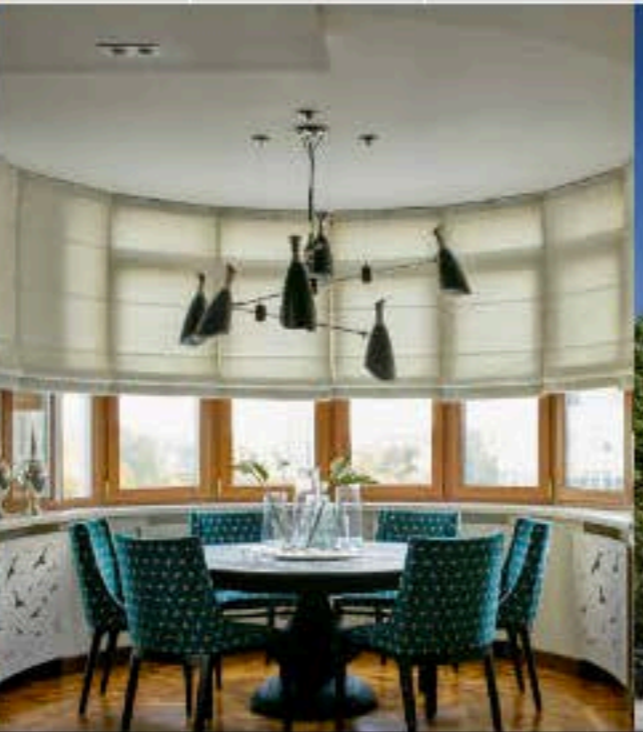

@ Interior Design



@ Architecture



@ Interior Design



"I saw the angel in the marble and carved until I set him free."  
- Michelangelo



Read More



Read More



Read More





## Villa in Cannes

The residence is perched above the city of Cannes, in an exclusive setting with a panoramic view over the surrounding area.

Read More

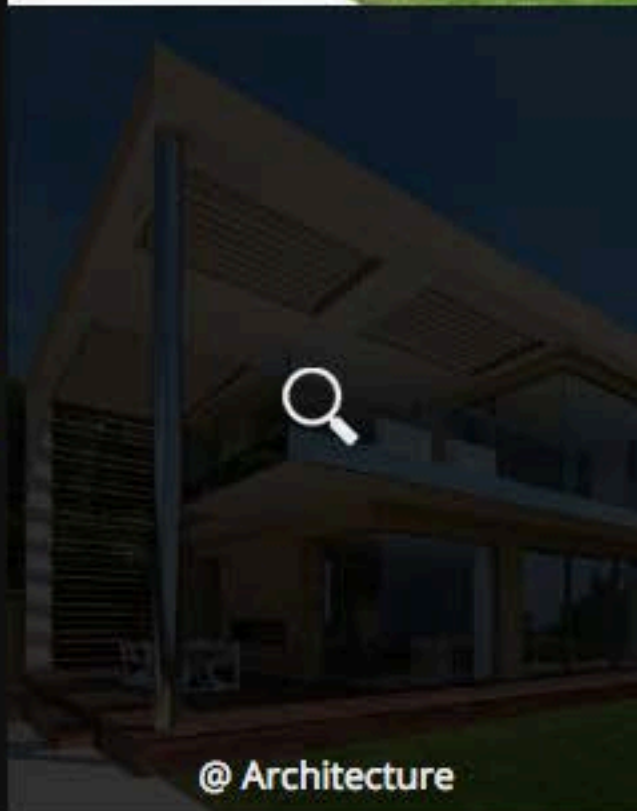

@ Architecture



@ Interior Design



@ Architecture



@ Interior Design





## Villa in Cannes

Like 0

Tweet

Pin it

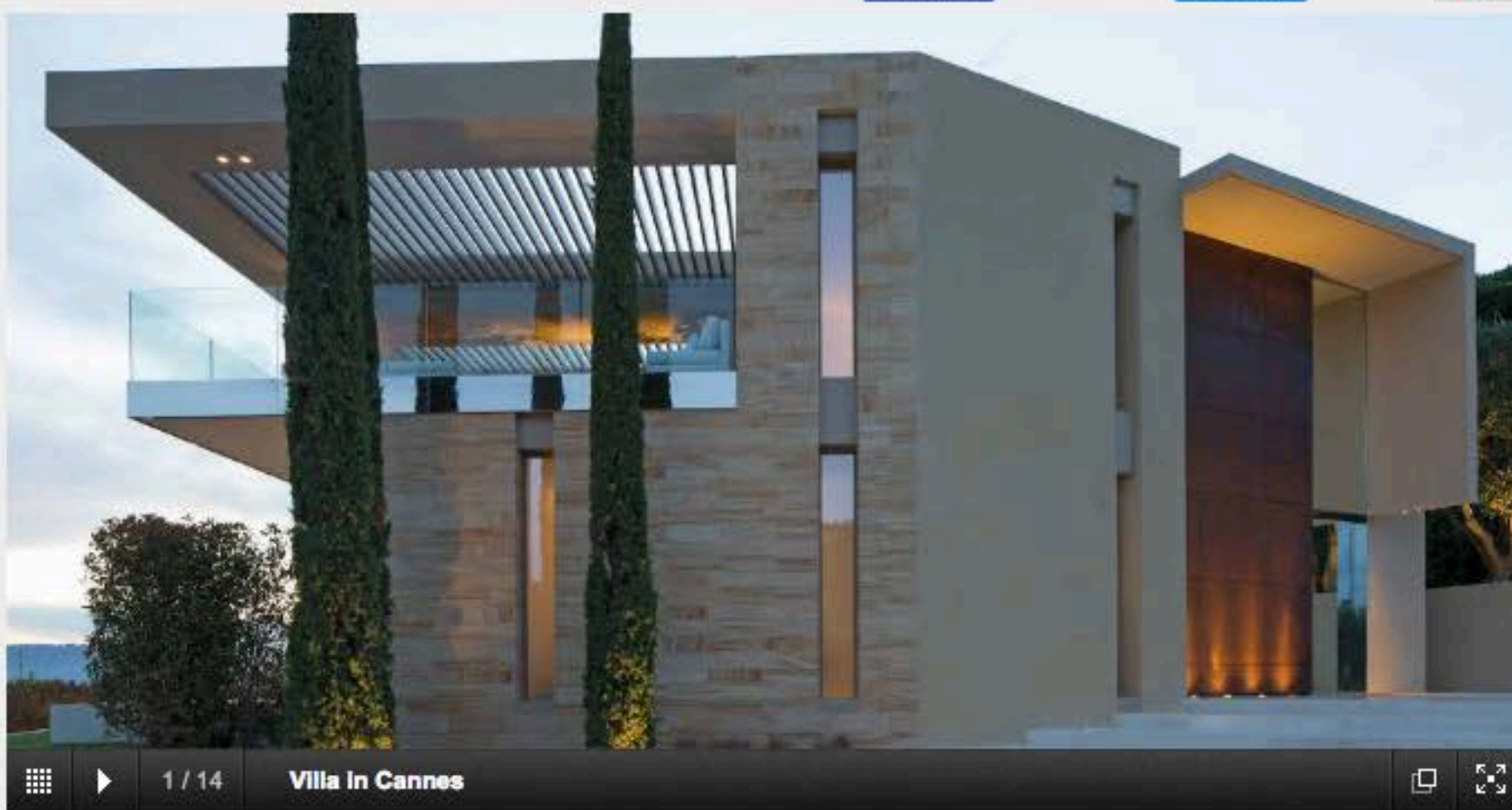

1 / 14 Villa In Cannes

Error: Not a valid Facebook Page url.

sto



StoTherm

Η Νο1 σειρά συστημάτων εξωτερικής θερμομόνωσης

Sto | Χτίζουμε με συνείδηση | www.stohellas.gr

the



PanTea

φυσικά πετρώματα

...με έμπνευση από τη φύση!



This contemporary home is modeled after a California-style villa. Its pure and simple lines are highlighted by the glass and polished stainless steel, which contrast with rough-hewn natural building materials such as stone, wood and Corten steel. The property is perched above the city of Cannes, in an exclusive setting with a panoramic view over the surrounding area. The entire project is made-to-measure (architecture, interior, garden and furnishings) making it a unique, one-of-its-kind offer.

The villa is designed to fit in seamlessly with all the principal exterior elements, like its spectacular view and the greenery of the beautifully landscaped grounds, enhanced by the architect's mineral sculptures. Thus, the transition between a sophisticated, contemporary form of architecture and a fragile and precious Mediterranean environment is defined. All fixtures and fittings of this private residence are designed in harmony with the guiding principles used in the architecture of the building itself: spacious and streamlined volumes are underscored by surface materials like wood, stone and metal.

The architect assigned his sister, Christine Bodino, to plan the home's interior design, resulting in an elegant and perfectly calculated interior, while he created tailor-made furnishings for the main spaces.

In overall, this project reflects the paradox that exists between the large scale of the outdoor areas and volumes of the living space, and the indisputable sense of serenity that reigns over the property.

Design by: Denis Bodino - DRC Studio

Photos by: Olivier Amsellem

